

# COMTrend

# G.HN 2000 POWERLINE + DC POWER OUTPUT

Second Generation G.hn Wave 2 Speeds | 12VDC 30W Output

## PG-9182DC

G.hn Powerline technology allows you to easily extend a home network via the existing electrical lines. Now, Comtrend's innovative PG-9182DC G.hn Powerline Adapter with DC power output, can both power the Gateway and connect it to the G.hn Powerline network at the same time. Simply add one additional adapter to create a powerful, high-speed G.hn network connection!

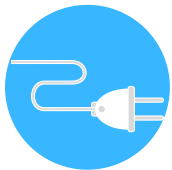

The PG-9182DC eliminates the need for the gateway to connect to both its power adapter and a separate G.hn powerline adapter when creating a G.hn network. It does both!

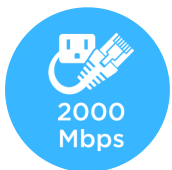

Blazing fast G.hn Wave 2 chipset speeds up to 2Gbps PHY rate over the powerline connection delivers up to 1Gbps through the Ethernet port.



Two adapters are required to make a connection. Connect up to 16 per network!



COMTrend

530 Technology Drive Suite 100

Irvine, CA 92618

(949) 753-9640 | [us.comtrend.com](http://us.comtrend.com)

DS\_PG-9182DC\_V1.0.1

### Easily Extend The Home Network!

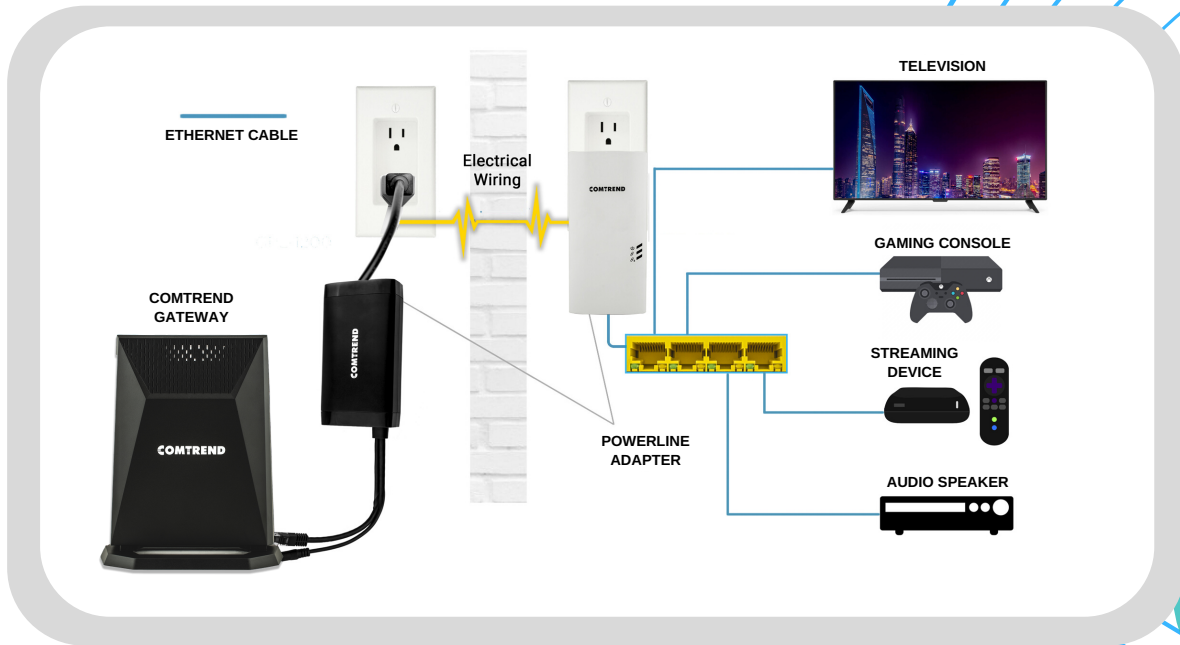

## Specifications

### Interface

RJ-45 X 1  
DC Output x 1 for 12VDC Output  
AC Power Jack x 1 for AC Power Cord  
LED Indicators: Power, Connection, Security, LAN  
Buttons: G.hn Pairing, Reset

### Ethernet

Standard IEEE 802.3  
10/100/1000 Mbps BaseT Auto-Sense  
Auto Rate and Duplex Negotiation  
MDI/MDX Support

### G.hn (PLC)

ITU-T G.9960 & G.9961 Compliant  
G.hn 100MHz MIMO  
Up to 2000Mbps Phy Rate  
NDIM Support

### Modulations

OFDM, FEC; Flexible Frequency Configuration

### Management

HTTP Web-Based  
TR-069

### Security

AES 128 Bits Encryption Ensures Total Data Security

### Networking Protocols

802.1D Ethernet Bridge  
802.1Q VLAN  
Quality of Service (QoS)  
IGMP(IPv4) Snooping & MLD(IPv6) Snooping

### AC Power

100-240 VAC, 50Hz/60Hz

### DC Power

12VDC/30W Under 86°F (30°C)  
12VDC/24W Under 104°F (40°C)  
DC Plug: 0.25cm ID x 0.55cm OD (2.5mm ID x 5.5mm OD)

### Environment Condition

Operating Temperature: 32°F~104°F (0°C ~ 40°C)  
Relative Humidity: 8 ~ 95% (non-condensing)

### Dimensions

1.54in (H) x 2.83in (W) x 5.20in (D)  
39mm (H) x 72mm (W) x 132mm (D)

### Certifications

FCC, UL, cUL, CE, ITU-T G.hn Standard

**Note: Specifications are subject to change without notice**